

ARRANJO DO FUNDO/PRAÇA MÁQUINAS

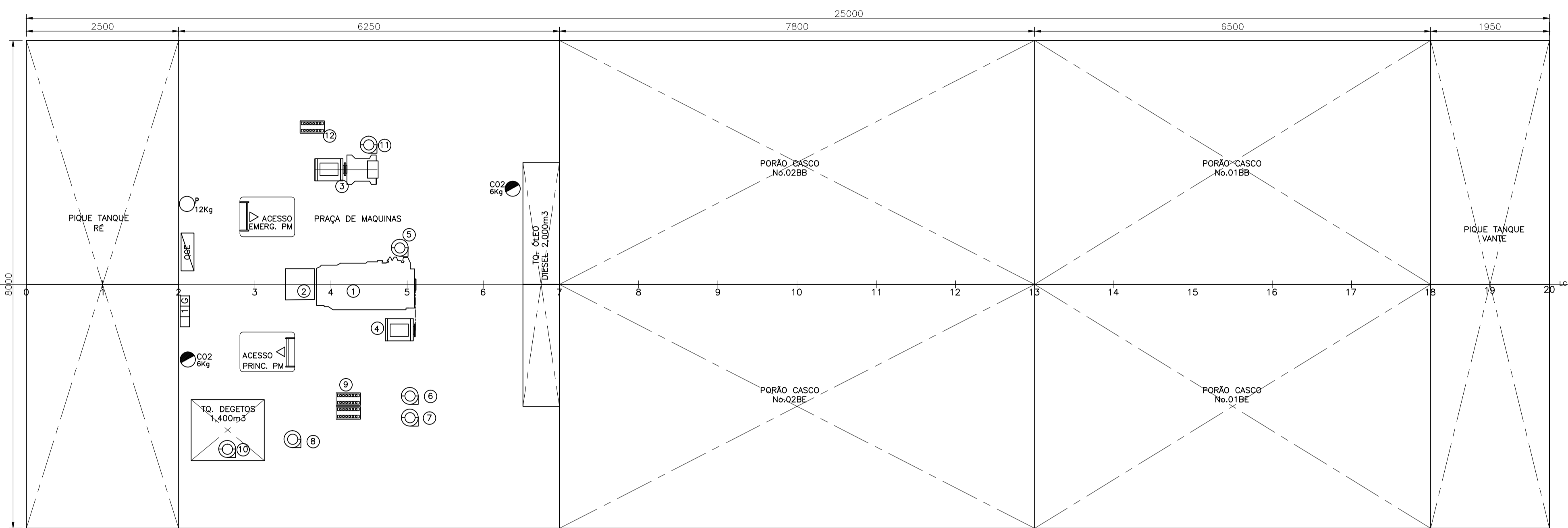

ARRANJO DO FUNDO/PRAÇA MÁQUINAS

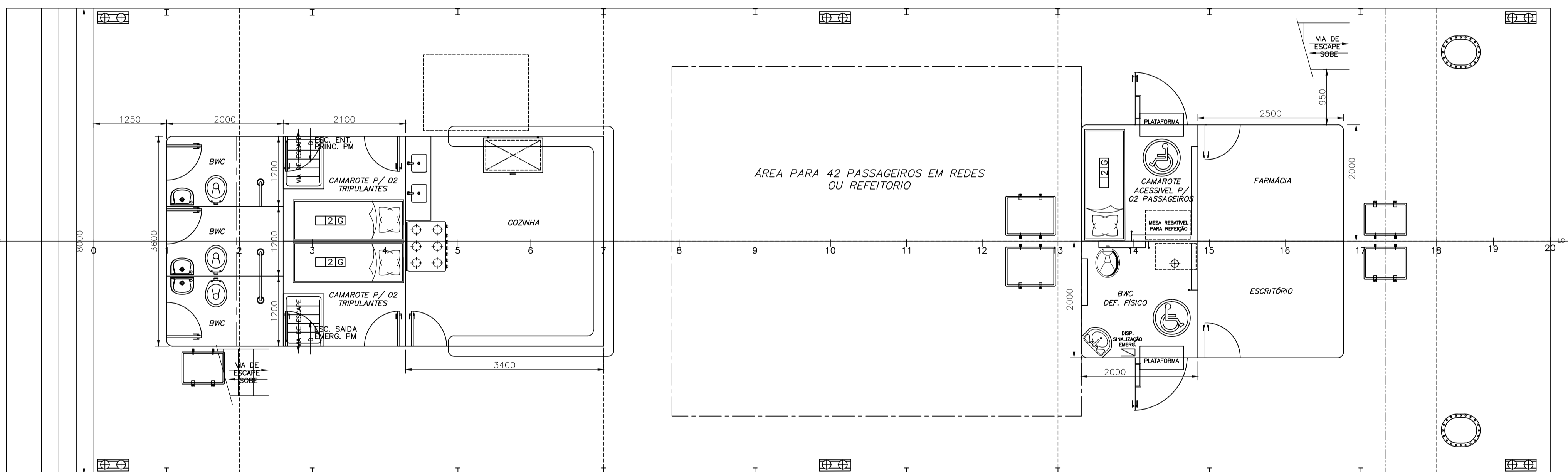

ARRANJO DO CONVÉS PRINCIPAL

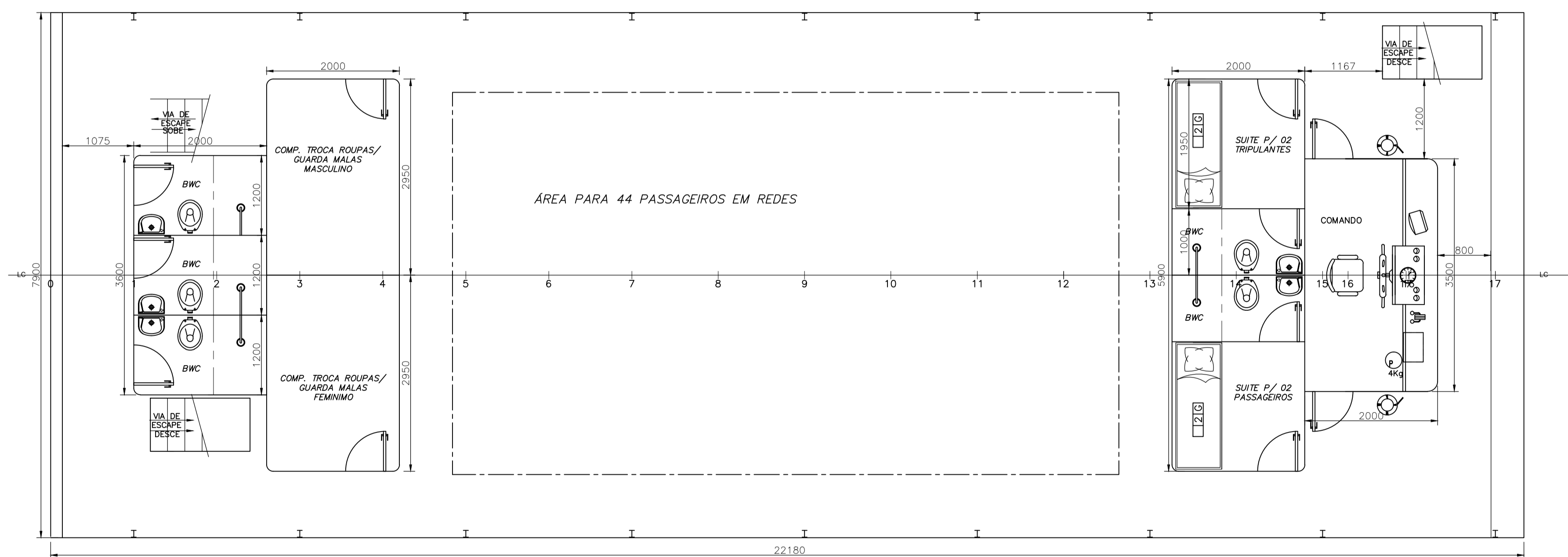

ARRANJO DO CONVÉS SUPERIOR/PASSADIÇO

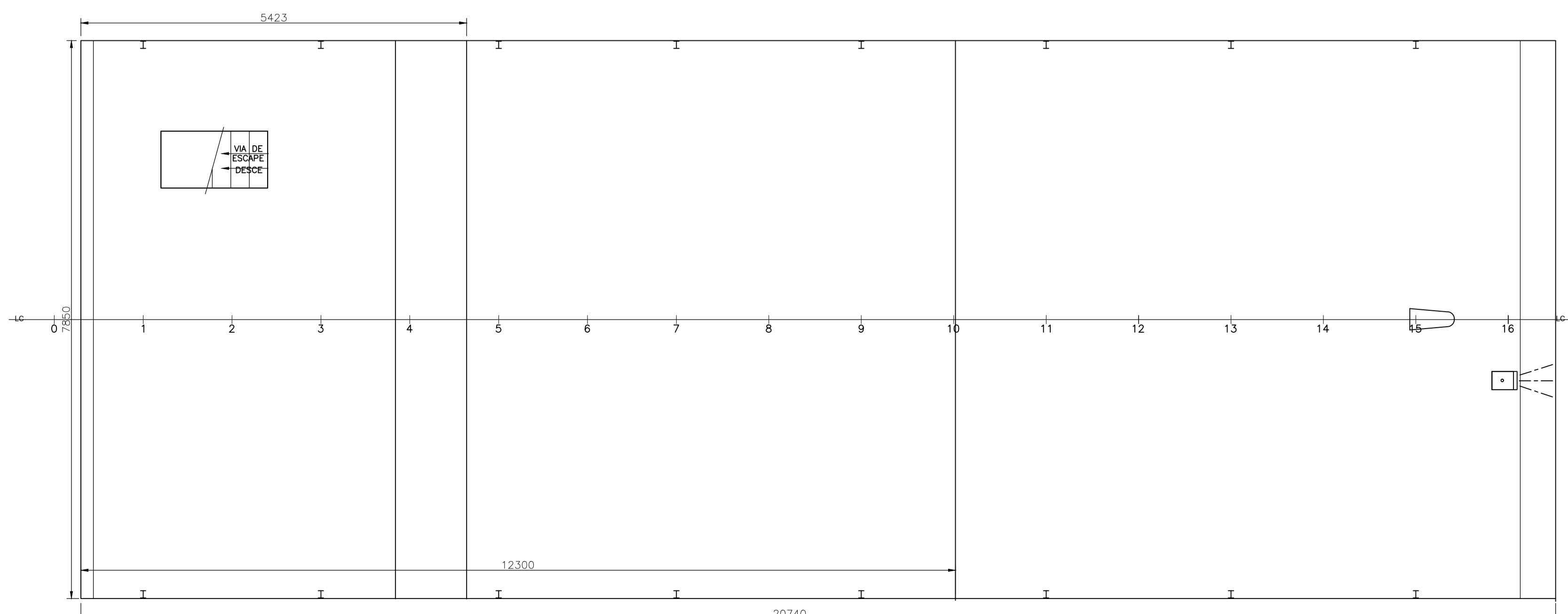

ARRANJO DO CONVÉS TIJUPA

Marlene Coimbra Braga
Eng. Naval
CREA 118390/PA

CARACTERÍSTICAS

| | |
|---------------------------|---------|
| COMPRIMENTO TOTAL | 25,300m |
| COMPRIMENTO CASCO | 25,000m |
| COMPRIMENTO ENTRE PP. | 24,000m |
| BOCA MOLDADA | 8,000m |
| PONTAL MOLDADO | 1,750m |
| CALADO MOLDADO DE PROJETO | 1,300m |

| | | | |
|----------------|--------------------------|------------|-----------|
| ARMADOR | | | |
| PROJETO | EMB. PASSAGEIROS E CARGA | | |
| NOME | "A DEFINIR" | | |
| CONSTRUTOR | | | |
| ENG. RESP. | Marlene G. Braga | CREA: | 118390/PA |
| TÍTULO | | | |
| ARRANJO GERAL, | | | |
| CALCULADO | | APROVADO | |
| PROJETO | Marlene G. Braga | DATA | MAR/2019 |
| DESENHO | | ESCALA | 1:50 |
| REVISÃO | | DESENHO N° | 01 |
| | | FOLHA | 1/1 |